

- Notes:
- If possible locate pond where vegetation exists.
  - Suggest minimal clearing to conserve visual quality of site and minimize the additional cost of tree planting. An irregular shape provides a more natural appearance.
  - Landscape strip shall be a maximum slope of 7:1 in order to plant vegetation.
  - Provide a minimum of 3 inches of mulch around all vegetation.

DATE: 5-24-06  
 SCALE: NTS  
 DRAWN BY: GC  
 CHECKED BY: MAM  
 SD 15-16

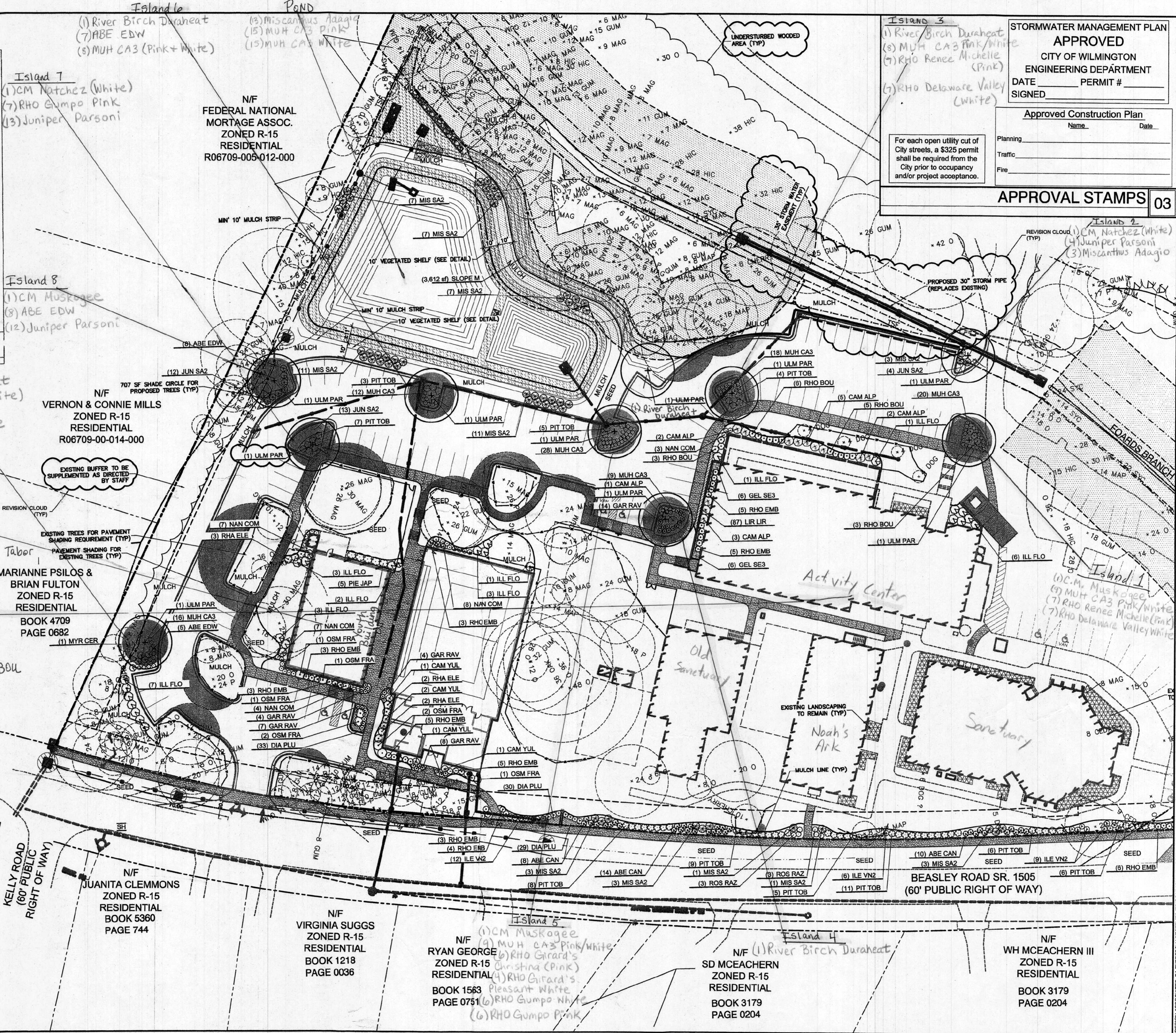

**STORMWATER MANAGEMENT PLAN**  
**APPROVED**  
 CITY OF WILMINGTON  
 ENGINEERING DEPARTMENT  
 DATE \_\_\_\_\_ PERMIT # \_\_\_\_\_  
 SIGNED \_\_\_\_\_

Approved Construction Plan  
 Name \_\_\_\_\_ Date \_\_\_\_\_

Planning \_\_\_\_\_  
 Traffic \_\_\_\_\_  
 Fire \_\_\_\_\_

For each open utility cut of City streets, a \$325 permit shall be required from the City prior to occupancy and/or project acceptance.

**APPROVAL STAMPS** 03

- Youth Building Substitutions**
- (5) Gardenia August Beauty sub for (5) Pieris Japonica
  - (6) Azalea Pink Ruffles sub for (6) Encore Embers
  - (3) Hawthorn Snow White sub for (3) Hawthorn Eleanor Tabor
  - (7) Nandina Gulfstream sub for (7) Nandina Compacta
- Activity Center Substitutions**
- (10) RHO Pink Ruffles sub for (10) RHO EMB
  - (12) Confederate Jasmine sub for (12) GEL SE3
  - (6) RHO Girard's Christina (pink) sub for (6) RHO BOU
  - (6) RHO Girard's Pleasant White (white) sub for (6) RHO BOU

**MASONBORO BAPTIST CHURCH**  
 CITY OF WILMINGTON  
 APPROVED PLANTING PLAN REVISION  
 12/9/20 BC

**CLINE DESIGN**

272 North Front Street  
 Suite 510  
 Wilmington, NC 28401  
 910/254-0222  
 910/254-0228 FAX  
 ClineDesignAssoc.com

**Masonboro Baptist Church**  
 1501 Beasley Road / 3420 Masonboro Loop Road  
 Wilmington, North Carolina 28405

Final TRC Submittal

REVISIONS:	DATE
2nd TRC	12.21.2010
Response to 2nd TRC	05.03.2011
SLP Sub	07.26.2011
Final Construction Review	09.13.2011
City Engineer Comments	12.28.2011
Final TRC Submittal	01.18.2012
Response to Final TRC Sub.	05.11.2012

DRAWN BY: SP  
 CHECKED BY: MWL/JBM  
 ENLARGED  
 LANDSCAPE PLAN

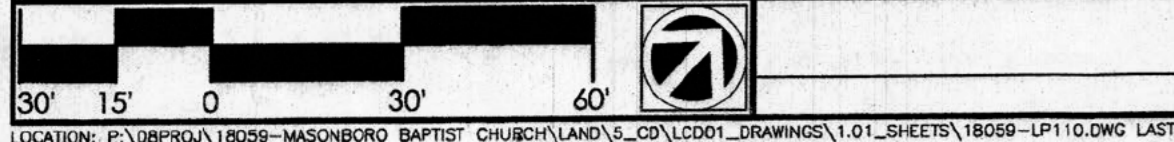



REVISIONS	DATE
2nd TRC	12.21.2010
Response to 2nd TRC	05.03.2011
SUP Sub	07.26.2011
Final Construction Review	09.13.2011
City Engineer Comments	12.28.2011
Final TRC Submittal	01.18.2012
Response to Final TRC Sub	05.11.2012

DRAWN BY: SP, CT  
CHECKED BY: JM, ML  
LANDSCAPE DETAILS AND PLANT SCHEDULE

- THE OWNERS SHALL BE RESPONSIBLE FOR ANNUAL MAINTENANCE OF THE VEGETATION TO INCLUDE BUT NOT LIMITED TO:
- FERTILIZATION** - ALL FESCUE TURFGRASS IS FERTILIZED AT THE TIME OF RENOVATION, TYPICALLY DURING THE LAST WEEK OF SEPTEMBER OR THE FIRST WEEK OF OCTOBER WITH 3/4 LB. NITROGEN, 1 LB PHOSPHOROUS, 1/2 LB POTASH PER 1000 SQ. FT. ONE MONTH LATER WE FERTILIZE AGAIN WITH 1 LB NITROGEN, A TRACE OF PHOSPHOROUS AND 1 LB. POTASH PER 1000 SQ. FT. THE SAME FERTILIZER AND RATES ARE APPLIED AGAIN IN FEBRUARY. TREES AND SHRUBBERY ARE FERTILIZED WITH AN ORGANIC FERTILIZER AT THE TIME OF PLANTING. ALL SHRUBS AND RECENTLY PLANTED TREES ARE FERTILIZED IN JANUARY WITH A COATED SLOW RELEASE FERTILIZER (12-14-14) AT THE APPROXIMATE RATE OF 1 LB. OF ACTUAL NUTRIENT PER 1000 SQ. FT.
  - PRUNING** - TYPICALLY TREES ARE PRUNED ONLY TO REPAIR DAMAGE OR TO CORRECT FAULTS. HEDGES AND SHAPED SHRUBS ARE TYPICALLY PRUNED TWICE DURING THE GROWING SEASON. OVERGROWN SHRUBS ARE PRUNED IN THE SPRING AND JUST PRIOR TO THE FIRST GROWTH FLUSH.
  - PEST CONTROL** - INSECTS ARE TREATED AS NECESSARY. LANDSCAPE CONTRACTOR FOR MAINTENANCE SHALL RECOMMEND PRODUCTS.
  - MULCHING** - THE IMMEDIATE ROOT ZONES OF ALL TREES AND SHRUBS ARE MULCHED WITH SHREDED HARDWOOD MULCH 3" THICK. SEASONAL COLOR BEDS ARE MULCHED WITH PINE BARK MULCH TO A DEPTH OF 1/4" TO 1/2".
  - MOWING** - FESCUE LAWNS ARE MOWED ONCE WEEKLY, OCTOBER THRU FEBRUARY. MARCH THRU JUNE THEY ARE MOWED TWICE WEEKLY. JULY THRU SEPTEMBER MOWING IS DONE ONE EVERY FIVE TO SEVEN DAYS.
  - OTHER CONTINUING MAINTENANCE OPERATIONS** WOULD INCLUDE SEASONAL COLOR PLANTINGS (FLOWERS). THESE PLANTINGS ARE DONE TWICE ANNUALLY, IN MAY AND AGAIN IN OCTOBER. THE PREVIOUS SEASONS FLOWERS ARE PULLED, THE BEDS ARE LIMED ACCORDING TO SOIL TEST RECOMMENDATIONS, FERTILIZED WITH ORGANIC FERTILIZER, PLANTED, MULCHED, WATERED, AND TREATED WITH A PRE-EMERGENT HERBICIDE.

**LANDSCAPE MAINTENANCE NOTES 03**

- VERIFICATION OF TOTAL LANDSCAPE MATERIAL QUANTITIES AS SHOWN ON THE LANDSCAPE PLANS AND IN THE SHALL BE NOTIFIED OF ANY DISCREPANCIES PRIOR TO FINAL BIDDING OR INSTALLATION.
- ALL LANDSCAPE MATERIALS SHALL CONFORM TO THE ACCEPTED STANDARDS ESTABLISHED BY THE AMERICAN ASSOCIATION OF NURSERMEN.
- LANDSCAPE MATERIAL PLANTED IN PREPARED HOLES SHALL BE PROPERLY BACKFILLED PRIOR TO THE END OF THE WORKING DAY.
- ALL SAUCERS SHALL BE SOAKED WITH WATER AND MULCHED IMMEDIATELY FOLLOWING INSTALLATION.
- ALL PREPARED GROUND COVER AND ANNUAL BED INSTALLATIONS SHALL BE PROPERLY SOAKED AND MULCHED PRIOR TO THE END OF THE DAY.
- LANDSCAPE ARCHITECT SHALL APPROVE ANY ON-SITE PLANT STORAGE AREA FOR ACCESSIBILITY, SHADE CONDITIONS, HEALING-IN MULCH MATERIAL AND TEMPORARY WATERING METHODS.
- ALL ROOT BALLS REMOVED FROM CONTAINERS SHALL BE SCARIFIED BY HAND PRIOR TO PLACEMENT AND BACK FILLING WITH PREPARED SOILS. HAND TOOLS ARE NOT TO BE USED TO SCARIFY ROOT BALLS.
- ALL ROPE AND WRAPPING TWINE SHALL BE CUT AND REMOVED FROM AROUND THE UPPER PARTS OF THE ROOT BALL. METAL BASKET WIRES AND BURLAP SHALL BE PULLED BACK AND TUCKED UNDER THE EDGES OF THE SAUCER RINGS ON ALL TREES AND LARGE SHRUBS. ALL SYNTHETIC BURLAP SHALL BE REMOVED FROM PLANT BALLS PRIOR TO BACK FILLING.
- ALL PLANT BEDS OR RAISED SAUCER RINGS SHALL BE EDGED WITH SMOOTH, CONTINUOUS CURVES. PINE STRAW MULCH, IF SPECIFIED, SHALL BE ROLLED AND TUCKED ALONG PLANT BED EDGE.
- ALL PLANT MATERIAL SHALL BE PLANTED AT HEIGHTS AS ILLUSTRATED IN PLANT DETAILS.
- TREE GUYING SHALL BE PERFORMED WITHIN A WEEK OF PLANTING. THE LANDSCAPE CONTRACTOR SHALL BE RESPONSIBLE FOR REMOVING ALL TREE GUYING STRAPPING AND STAKES AFTER THE FIRST FULL GROWING SEASON OR ONE YEAR, WHICHEVER COMES FIRST.
- CONTRACTOR SHALL VERIFY LOCATIONS OF UNDERGROUND UTILITIES PRIOR TO PLANTING. ANY EXPOSED OR UNCOVERED LINES SHALL BE SAUCER TO GENERAL CONTRACTOR PRIOR TO BACKFILLING.
- ALL PLANT BEDS AND RAISED SAUCER RINGS SHALL BE GRADED TO PROVIDE ADEQUATE DRAINAGE AND SHALL BE MULCHED AS SPECIFIED.
- ALL MATERIALS, PLANTING AND LANDSCAPE WORK SHALL CONFORM TO THE CURRENT MUNICIPAL AUTHORITY'S STANDARD SPECIFICATIONS AND DETAILS.
- ALL LANDSCAPE AREAS THAT ARE NOT PLANTED AND MULCHED OR PAVED SHALL BE SEEDED OR SODDED.
- TREE PROTECTION FENCE SHALL BE INSTALLED, INSPECTED AND APPROVED PRIOR TO THE ISSUANCE OF ANY GRADING OR OTHER PERMITS.
- FIRST YEAR PRUNING OF TREE CROWN SHALL BE LIMITED TO REMOVAL OF DEAD & DAMAGED WOOD.
- TREE PROTECTION FENCE SHALL BE INSTALLED, INSPECTED AND APPROVED PRIOR TO CLEARING, GRADING, AND CONSTRUCTION ACTIVITY OR THE ISSUANCE OF ANY RELATED PERMITS. NO CONSTRUCTION WORKERS, TOOLS, MATERIALS OR VEHICLES ARE PERMITTED WITHIN THE TREE PROTECTION FENCING.
- MULCH LINE SMOOTH CONTINUOUS CURVES. CLEAR OUT FIRST 5' FROM DEBRIS AND UNDERBRUSH (TYP) AT AREAS OF EXISTING VEGETATION TO REMAIN.
- ALL TREES NOT WITHIN A PLANT BED TO BE TREATED WITH A 6" DIAMETER MULCH RING (TYP).

- GENERAL NOTES:
- THOROUGHLY TILL IN PLANTING MIXTURE AMENDMENTS TO A DEPTH OF 6" IN ENTIRE BED AREA.
  - WORK SOIL TO A LOOSE, UNIFORM TEXTURE.
  - HAND-TAMP BACKFILL TO REMOVE VOIDS/AIR POCKETS.
  - WATER IMMEDIATELY AFTER INSTALLATION UNTIL NO MORE WATER IS ABSORBED.

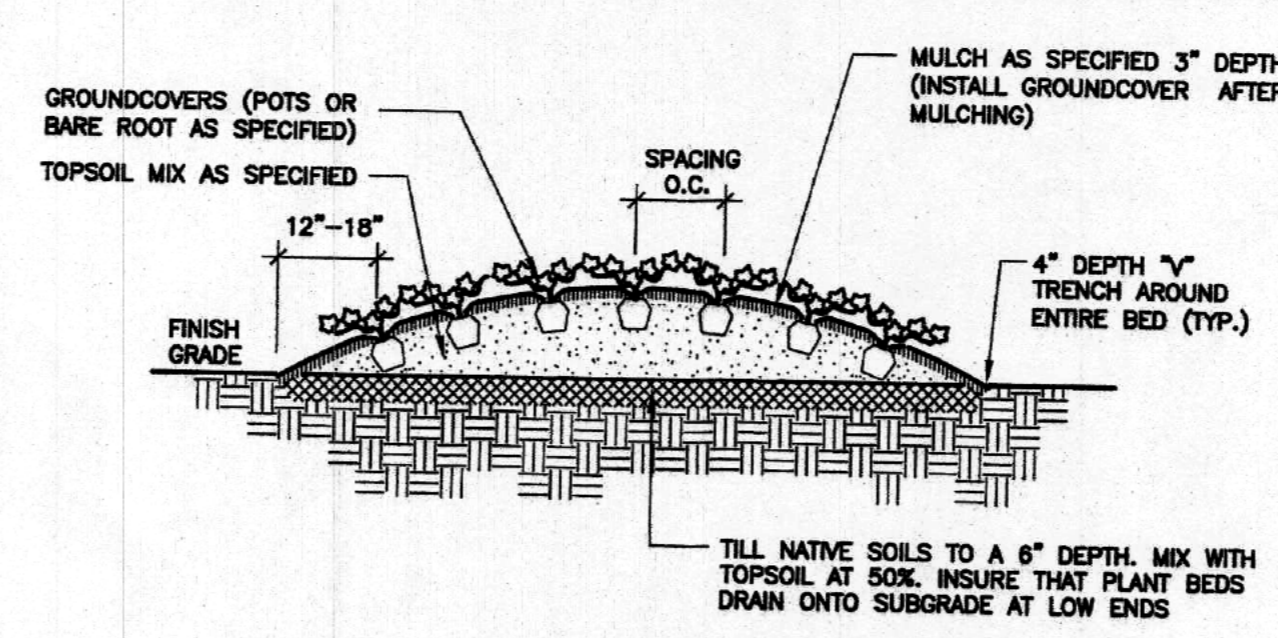

**TYPICAL GROUND COVER PLANTING 06**

- GENERAL NOTES:
- SCARIFY SIDES AND BOTTOM OF PLANTING PIT.
  - BACKFILL PLANTING PIT WITH SPECIFIED PLANTING SOIL MIXTURE (OR AMENDED SOIL) IN 6" LAYERS, HAND-TAMPED, TO REMOVE VOIDS.
  - WHEN PLANTING PIT IS 2/3 BACKFILLED, WATER MATERIAL.
  - AFTER PLACING AND HAND-TAMPING FINAL LAYERS, WATER AGAIN UNTIL NO MORE IS ABSORBED.

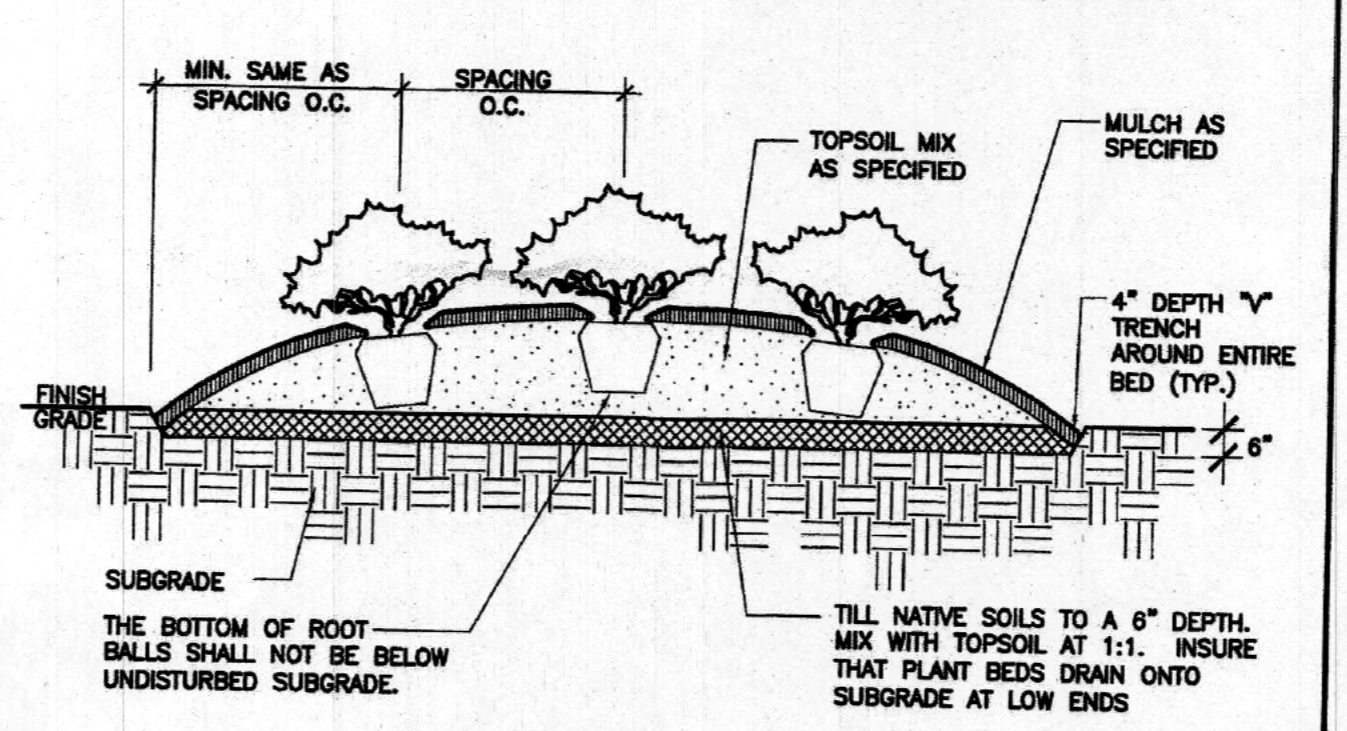

**TYPICAL SHRUB PLANTING 03**

- GENERAL NOTES:
- PLANT SO THAT TOP OF ROOT BALL IS 2" ABOVE FINISH GRADE.
  - SCARIFY SIDES AND BOTTOM OF PLANTING PIT.
  - BACKFILL TREE PIT WITH SPECIFIED PLANTING SOIL MIXTURE (OR AMENDED SOIL) IN 6" LAYERS, HAND-TAMPED, TO REMOVE VOIDS.
  - WHEN PLANTING PIT IS 2/3 BACKFILLED, WATER MATERIAL.
  - AFTER PLACING AND HAND-TAMPING FINAL LAYERS, WATER AGAIN UNTIL NO MORE IS ABSORBED.
  - STAKE AND GUY TREES IF APPLICABLE. (TREES 3" CALIPER AND LARGER OR IN WINDY CONDITIONS AS DIRECTED BY LANDSCAPE ARCHITECT.)
  - DO NOT WRAP TREE TRUNKS.

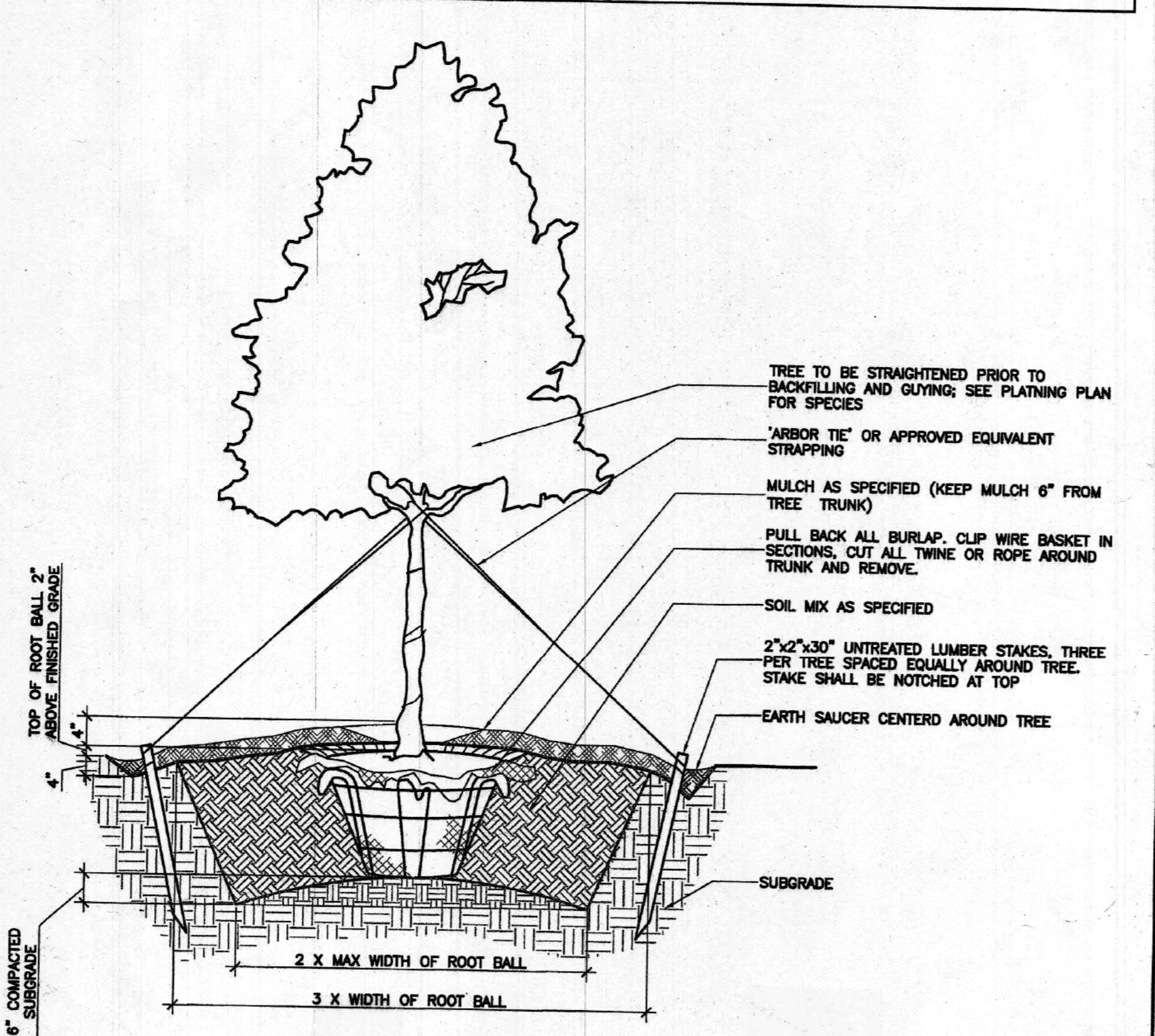

Trees	Quantity	Botanical Name	Common Name	Caliper	Height	Spread	Remarks
1	1	Betula nigra	Silver Birch	2.5"	10-12'	7-8'	(6) substituted for (6) Chinese Elm
2	1	Lagerstroemia x Natchez	Crape Myrtle Natchez	2.5"	9-10'	6-8'	(2) substituted for (2) Chinese Elm
3	1	Lagerstroemia x Muskogee	Crape Myrtle Muskogee	2.5"	9-10'	6-8'	(2) substituted for (2) Chinese Elm
4	1	Rhododendron 'Savannah Valley White'	Renee Michelle Azalea	#3	12-18"	12-18"	(14) substituted for (14) Multi Grass
5	1	Rhododendron 'Savannah Valley White'	Delaware Valley White Azalea	#3	24-36"	18-24"	(4) substituted for (4) Sarabande Eulalia Grass
6	1	Rhododendron 'Savannah Valley White'	Eulalia Azalea	#3	12-18"	12-18"	(6) Azalea Girard's Christina (pink) substituted for (6) Multi grass
7	1	Rhododendron 'Savannah Valley White'	Girard's Christina Azalea	#3	12-18"	12-18"	(6) Azalea Girard's Christina (pink) substituted for (6) Multi grass
8	1	Rhododendron 'Savannah Valley White'	Girard's Pleasant White Azalea	#3	12-18"	12-18"	(6) Azalea Girard's Pleasant White (white) substituted for (6) Multi grass
9	1	Rhododendron 'Savannah Valley White'	Girard's Pleasant White Azalea	#3	12-18"	12-18"	(6) Azalea Girard's Pleasant White (white) substituted for (6) Multi grass
10	1	Rhododendron 'Savannah Valley White'	Girard's Pleasant White Azalea	#3	12-18"	12-18"	(6) Azalea Girard's Pleasant White (white) substituted for (6) Multi grass
11	1	Rhododendron 'Savannah Valley White'	Girard's Pleasant White Azalea	#3	12-18"	12-18"	(6) Azalea Girard's Pleasant White (white) substituted for (6) Multi grass
12	1	Rhododendron 'Savannah Valley White'	Girard's Pleasant White Azalea	#3	12-18"	12-18"	(6) Azalea Girard's Pleasant White (white) substituted for (6) Multi grass
13	1	Rhododendron 'Savannah Valley White'	Girard's Pleasant White Azalea	#3	12-18"	12-18"	(6) Azalea Girard's Pleasant White (white) substituted for (6) Multi grass
14	1	Rhododendron 'Savannah Valley White'	Girard's Pleasant White Azalea	#3	12-18"	12-18"	(6) Azalea Girard's Pleasant White (white) substituted for (6) Multi grass
15	1	Rhododendron 'Savannah Valley White'	Girard's Pleasant White Azalea	#3	12-18"	12-18"	(6) Azalea Girard's Pleasant White (white) substituted for (6) Multi grass
16	1	Rhododendron 'Savannah Valley White'	Girard's Pleasant White Azalea	#3	12-18"	12-18"	(6) Azalea Girard's Pleasant White (white) substituted for (6) Multi grass
17	1	Rhododendron 'Savannah Valley White'	Girard's Pleasant White Azalea	#3	12-18"	12-18"	(6) Azalea Girard's Pleasant White (white) substituted for (6) Multi grass
18	1	Rhododendron 'Savannah Valley White'	Girard's Pleasant White Azalea	#3	12-18"	12-18"	(6) Azalea Girard's Pleasant White (white) substituted for (6) Multi grass
19	1	Rhododendron 'Savannah Valley White'	Girard's Pleasant White Azalea	#3	12-18"	12-18"	(6) Azalea Girard's Pleasant White (white) substituted for (6) Multi grass
20	1	Rhododendron 'Savannah Valley White'	Girard's Pleasant White Azalea	#3	12-18"	12-18"	(6) Azalea Girard's Pleasant White (white) substituted for (6) Multi grass
21	1	Rhododendron 'Savannah Valley White'	Girard's Pleasant White Azalea	#3	12-18"	12-18"	(6) Azalea Girard's Pleasant White (white) substituted for (6) Multi grass
22	1	Rhododendron 'Savannah Valley White'	Girard's Pleasant White Azalea	#3	12-18"	12-18"	(6) Azalea Girard's Pleasant White (white) substituted for (6) Multi grass
23	1	Rhododendron 'Savannah Valley White'	Girard's Pleasant White Azalea	#3	12-18"	12-18"	(6) Azalea Girard's Pleasant White (white) substituted for (6) Multi grass
24	1	Rhododendron 'Savannah Valley White'	Girard's Pleasant White Azalea	#3	12-18"	12-18"	(6) Azalea Girard's Pleasant White (white) substituted for (6) Multi grass
25	1	Rhododendron 'Savannah Valley White'	Girard's Pleasant White Azalea	#3	12-18"	12-18"	(6) Azalea Girard's Pleasant White (white) substituted for (6) Multi grass
26	1	Rhododendron 'Savannah Valley White'	Girard's Pleasant White Azalea	#3	12-18"	12-18"	(6) Azalea Girard's Pleasant White (white) substituted for (6) Multi grass
27	1	Rhododendron 'Savannah Valley White'	Girard's Pleasant White Azalea	#3	12-18"	12-18"	(6) Azalea Girard's Pleasant White (white) substituted for (6) Multi grass
28	1	Rhododendron 'Savannah Valley White'	Girard's Pleasant White Azalea	#3	12-18"	12-18"	(6) Azalea Girard's Pleasant White (white) substituted for (6) Multi grass
29	1	Rhododendron 'Savannah Valley White'	Girard's Pleasant White Azalea	#3	12-18"	12-18"	(6) Azalea Girard's Pleasant White (white) substituted for (6) Multi grass
30	1	Rhododendron 'Savannah Valley White'	Girard's Pleasant White Azalea	#3	12-18"	12-18"	(6) Azalea Girard's Pleasant White (white) substituted for (6) Multi grass
31	1	Rhododendron 'Savannah Valley White'	Girard's Pleasant White Azalea	#3	12-18"	12-18"	(6) Azalea Girard's Pleasant White (white) substituted for (6) Multi grass
32	1	Rhododendron 'Savannah Valley White'	Girard's Pleasant White Azalea	#3	12-18"	12-18"	(6) Azalea Girard's Pleasant White (white) substituted for (6) Multi grass
33	1	Rhododendron 'Savannah Valley White'	Girard's Pleasant White Azalea	#3	12-18"	12-18"	(6) Azalea Girard's Pleasant White (white) substituted for (6) Multi grass
34	1	Rhododendron 'Savannah Valley White'	Girard's Pleasant White Azalea	#3	12-18"	12-18"	(6) Azalea Girard's Pleasant White (white) substituted for (6) Multi grass
35	1	Rhododendron 'Savannah Valley White'	Girard's Pleasant White Azalea	#3	12-18"	12-18"	(6) Azalea Girard's Pleasant White (white) substituted for (6) Multi grass
36	1	Rhododendron 'Savannah Valley White'	Girard's Pleasant White Azalea	#3	12-18"	12-18"	(6) Azalea Girard's Pleasant White (white) substituted for (6) Multi grass
37	1	Rhododendron 'Savannah Valley White'	Girard's Pleasant White Azalea	#3	12-18"	12-18"	(6) Azalea Girard's Pleasant White (white) substituted for (6) Multi grass
38	1	Rhododendron 'Savannah Valley White'	Girard's Pleasant White Azalea	#3	12-18"	12-18"	(6) Azalea Girard's Pleasant White (white) substituted for (6) Multi grass
39	1	Rhododendron 'Savannah Valley White'	Girard's Pleasant White Azalea	#3	12-18"	12-18"	(6) Azalea Girard's Pleasant White (white) substituted for (6) Multi grass
40	1	Rhododendron 'Savannah Valley White'	Girard's Pleasant White Azalea	#3	12-18"	12-18"	(6) Azalea Girard's Pleasant White (white) substituted for (6) Multi grass
41	1	Rhododendron 'Savannah Valley White'	Girard's Pleasant White Azalea	#3	12-18"	12-18"	(6) Azalea Girard's Pleasant White (white) substituted for (6) Multi grass
42	1	Rhododendron 'Savannah Valley White'	Girard's Pleasant White Azalea	#3	12-18"	12-18"	(6) Azalea Girard's Pleasant White (white) substituted for (6) Multi grass
43	1	Rhododendron 'Savannah Valley White'	Girard's Pleasant White Azalea	#3	12-18"	12-18"	(6) Azalea Girard's Pleasant White (white) substituted for (6) Multi grass
44	1	Rhododendron 'Savannah Valley White'	Girard's Pleasant White Azalea	#3	12-18"	12-18"	(6) Azalea Girard's Pleasant White (white) substituted for (6) Multi grass
45	1	Rhododendron 'Savannah Valley White'	Girard's Pleasant White Azalea	#3	12-18"	12-18"	(6) Azalea Girard's Pleasant White (white) substituted for (6) Multi grass
46	1	Rhododendron 'Savannah Valley White'	Girard's Pleasant White Azalea	#3	12-18"	12-18"	(6) Azalea Girard's Pleasant White (white) substituted for (6) Multi grass
47	1	Rhododendron 'Savannah Valley White'	Girard's Pleasant White Azalea	#3	12-18"	12-18"	(6) Azalea Girard's Pleasant White (white) substituted for (6) Multi grass
48	1	Rhododendron 'Savannah Valley White'	Girard's Pleasant White Azalea	#3	12-18"	12-18"	(6) Azalea Girard's Pleasant White (white) substituted for (6) Multi grass
49	1	Rhododendron 'Savannah Valley White'	Girard's Pleasant White Azalea	#3	12-18"	12-18"	(6) Azalea Girard's Pleasant White (white) substituted for (6) Multi grass
50	1	Rhododendron 'Savannah Valley White'	Girard's Pleasant White Azalea	#3	12-18"	12-18"	(6) Azalea Girard's Pleasant White (white) substituted for (6) Multi grass
51	1	Rhododendron 'Savannah Valley White'	Girard's Pleasant White Azalea	#3	12-18"	12-18"	(6) Azalea Girard's Pleasant White (white) substituted for (6) Multi grass
52	1	Rhododendron 'Savannah Valley White'	Girard's Pleasant White Azalea	#3	12-18"	12-18"	(6) Azalea Girard's Pleasant White (white) substituted for (6) Multi grass
53	1	Rhododendron 'Savannah Valley White'	Girard's Pleasant White Azalea	#3	12-18"	12-18"	(6) Azalea Girard's Pleasant White (white) substituted for (6) Multi grass
54	1	Rhododendron 'Savannah Valley White'	Girard's Pleasant White Azalea	#3	12-18"	12-18"	(6) Azalea Girard's Pleasant White (white) substituted for (6) Multi grass
55	1	Rhododendron 'Savannah Valley White'	Girard's Pleasant White Azalea	#3	12-18"	12-18"	(6) Azalea Girard's Pleasant White (white) substituted for (6) Multi grass
56	1	Rhododendron 'Savannah Valley White'	Girard's Pleasant White Azalea	#3	12-18"	12-18"	(6) Azalea Girard's Pleasant White (white) substituted for (6) Multi grass
57	1	Rhododendron 'Savannah Valley White'	Girard's Pleasant White Azalea	#3	12-18"	12-18"	(6) Azalea Girard's Pleasant White (white) substituted for (6) Multi grass
58	1	Rhododendron 'Savannah Valley White'	Girard's Pleasant White Azalea	#3	12-18"	12-18"	(6) Azalea Girard's Pleasant White (white) substituted for (6) Multi grass
59	1	Rhododendron 'Savannah Valley White'	Girard's Pleasant White Azalea	#3	12-18"	12-18"	(6) Azalea Girard's Pleasant White (white) substituted for (6) Multi grass
60	1	Rhododendron 'Savannah Valley White'	Girard's Pleasant White Azalea	#3	12-18"	12-18"	(6) Azalea Girard's Pleasant White (white) substituted for (6) Multi grass
61	1	Rhododendron 'Savannah Valley White'	Girard's Pleasant White Azalea	#3	12-18"	12-18"	(6) Azalea Girard's Pleasant White (white) substituted for (6) Multi grass
62	1	Rhododendron 'Savannah Valley White'	Girard's Pleasant White Azalea	#3	12-18"	12-18"	(6) Azalea Girard's Pleasant White (white) substituted for (6) Multi grass
63	1	Rhododendron 'Savannah Valley White'	Girard's Pleasant White Azalea	#3	12-18"	12-18"	(6) Azalea Girard's Pleasant White (white) substituted for (6) Multi grass
64	1	Rhododendron 'Savannah Valley White'	Girard's Pleasant White Azalea	#3	12-18"	12-18"	(6) Azalea Girard's Pleasant White (white) substituted for (6) Multi grass
65	1	Rhododendron 'Savannah Valley White'	Girard's Pleasant White Azalea	#3	12-18"	12-18"	(6) Azalea Girard's Pleasant White (white) substituted for (6) Multi grass
66	1	Rhododendron 'Savannah Valley White'	Girard's Pleasant White Azalea	#3	12-18"	12-18"	(6) Azalea Girard's Pleasant White (white) substituted for (6) Multi grass
67	1	Rhododendron 'Savannah Valley White'	Girard's Pleasant White Azalea	#3	12-18"	12-18"	(6) Azalea Girard's Pleasant White (white) substituted for (6) Multi grass
68	1	Rhododendron 'Savannah Valley White'	Girard's Pleasant White Azalea	#3	12-18"	12-18"	(6) Azalea Girard's Pleasant White (white) substituted for (6) Multi grass
69	1	Rhododendron 'Savannah Valley White'	Girard's Pleasant White Azalea	#3	12-18"	12-18"	(6) Azalea Girard's Pleasant White (white) substituted for (6) Multi grass
70	1	Rhododendron 'Savannah Valley White'	Girard's Pleasant White Azalea	#3	12-18"	12-18"	(6) Azalea Girard's Pleasant White (white) substituted for (6) Multi grass
71	1	Rhododendron 'Savannah Valley White'	Girard's Pleasant White Azalea	#3	12-18"	12-18"	(6) Azalea Girard's Pleasant White (white) substituted for (6) Multi grass
72	1	Rhododendron 'Savannah Valley White'	Girard's Pleasant White Azalea	#3	12-18"	12-18"	(6) Azalea Girard's Pleasant White (white) substituted for (6) Multi grass
73	1	Rhododendron 'Savannah Valley White'	Girard's Pleasant White Azalea	#3	12-18"	12-18"	(6) Azalea Girard's Pleasant White (white) substituted for (6) Multi grass
74	1	Rhododendron 'Savannah Valley White'	Girard's Pleasant White Azalea	#3	12-18"	12-18"	(6) Azalea Girard's Pleasant White (white) substituted for (6) Multi grass
75	1	Rhododendron 'Savannah Valley White'	Girard's Pleasant White Azalea	#3	12-18"	12-18"	(6) Azalea Girard's Pleasant White (white) substituted for (6) Multi grass
76	1	Rhododendron 'Savannah Valley White'	Girard's Pleasant White Azalea	#3	12-18"	12-18"	(6) Azalea Girard's Pleasant White (white) substituted for (6) Multi grass
77	1	Rhododendron 'Savannah Valley White'	Girard's Pleasant White Azalea	#3	12-18"	12-18"	(6) Azalea Girard's Pleasant White (white) substituted for (6) Multi grass
78	1	Rhododendron 'Savannah Valley White'	Girard's Pleasant White Azalea	#3	12-18"	12-18"	(6) Azalea Girard's Pleasant White (white) substituted for (6) Multi grass
79	1	Rhododendron 'Savannah Valley White'	Girard's Pleasant White Azalea	#3	12-18"	12-18"	(6) Azalea Girard's Pleasant White (white) substituted for (6) Multi grass
80	1	Rhododendron 'Savannah Valley White'	Girard's Pleasant White Azalea	#3	12-18"	12-18"	(6) Azalea Girard's Pleasant White (white) substituted for (6) Multi grass
81	1	Rhododendron 'Savannah Valley White'	Girard's Pleasant White Azalea	#3	12-18"	12-18"	(6) Azalea Girard's Pleasant White (white) substituted for (6) Multi grass
82	1	Rhododendron 'Savannah Valley White'	Girard's Pleasant White Azalea	#3	12-18"	12-18"	(6) Azalea Girard's Pleasant White (white) substituted for (6) Multi grass
83	1	Rhododendron 'Savannah Valley White'	Girard's Pleasant White Azalea	#3	12-18"	12-18"	(6) Azalea Girard's Pleasant White (white) substituted for (6) Multi grass
84	1	Rhododendron 'Savannah Valley White'	Girard's Pleasant White Azalea	#3	12-18"	12-18"	(6) Azalea Girard's Pleasant White (white) substituted for (6) Multi grass
85	1						